

RPT975N300-50-5

FLANGE TERMINATION

- Substrate: Aluminum Nitride
- Resistive Film: Thick Film
- Tabs: Silver Plated Beryllium Copper
- Flange: Nickel plated Copper
- Cover: Alumina
- Impedance: 50 Ohms
- Tolerance: $\pm 5\%$
- Operating Temperature: -55°C to $+150^{\circ}\text{C}$

Part Number	Power (W)	Frequency (GHz)	MAX VSWR
RPT975N300-50-5	300	2.4-2.5	1.12:1

Dimensions: inches [mm]; Tolerance: .XXX = ± 0.010 ; .XX = ± 0.015

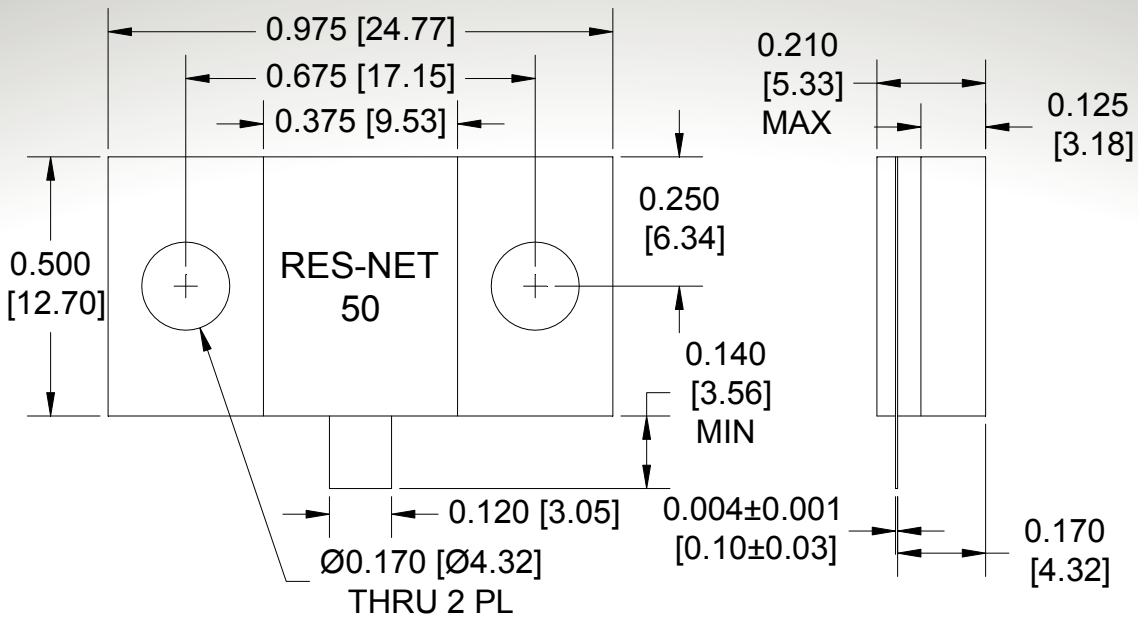

Ordering Information:

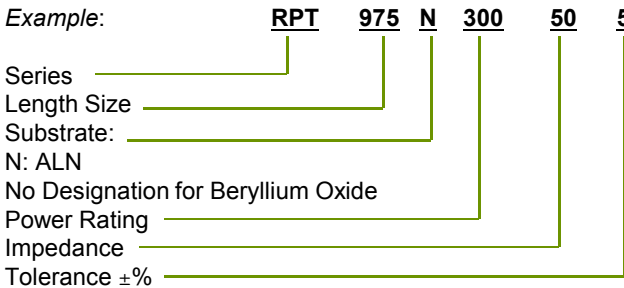

DERATING CURVE
(20W - 800W)

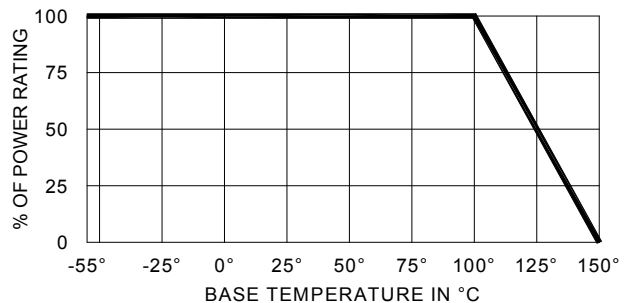

5410 115th Ave. North · Clearwater, FL 33760
727.530.9555 PH · 727.535.3508 FX
www.res-netmicrowave.com

PRELIMINARY
REV. 02
1/6/16

